



Max width single leaf

2,2 - 7 m

Use frequency (cycles/hour)

50 - 70

- Key-protected, release device
- Extremely silent movement.
- Hydraulic lock resistant to intrusion attempts (mod. CBC - CBAC).



SAFEzone system:
400 + E045 or E145 +
SAFEcoder



GREENTech system:
400 + E045 or E145



DIMENSIONS AND TECHNICAL SPECIFICATIONS

Model	400 CBC	400 CBAC	400 SB	400 SBS	400 CBAC L	400 SBS L
Power supply voltage	220-240V~ 50/60 Hz	220-240V~ 50/60 Hz	220-240V~ 50/60 Hz	220-240V~ 50/60 Hz	220-240V~ 50/60 Hz	220-240V~ 50/60 Hz
Motor	Asynchronous single phase	Asynchronous single phase	Asynchronous single phase	Asynchronous single phase	Asynchronous single phase	Asynchronous single phase
Max. power	220 W	220 W	220 W	220 W	220 W	220 W
Max expressed force	6200 N (*)	6200 N (*)	6200 N (*)	7750 N (*)	4650 N (*)	7750 N (*)
Rod max speed	10 mm/s (*)	10 mm/s (*)	10 mm/s (*)	7,5 mm/s (*)	15 mm/s (*)	7,5 mm/s (*)
Motor-pump unit capacity	1 lpm (*)	1 lpm (*)	1 lpm (*)	0,75 lpm (*)	1,5 lpm (*)	0,75 lpm (*)
Rod travel	270 mm	270 mm	270 mm	270 mm	390 mm	390 mm
Max. leaf opening angle	125°	125°	125°	125°	125°	125°
Operating ambient temperature	-20°C ÷ + 55°C	-20°C ÷ + 55°C	-20°C ÷ + 55°C	-20°C ÷ + 55°C	-20°C ÷ + 55°C	-20°C ÷ + 55°C
Thermal protection	120°C	120°C	120°C	120°C	120°C	120°C
Protection class	IP55	IP55	IP55	IP55	IP55	IP55
Weight	8.6 Kg	8.6 Kg	8.6 Kg	8.6 Kg	10 kg	10 kg
Use frequency	70 cycles/hour	70 cycles/hour	70 cycles/hour	60 cycles/hour	50 cycles/hour	40 cycles/hour
Max. leaf width	2.20 m	2.20 m	4,00 m (with electric lock)	7,00 m (with electric lock)	2.20 m	7,00 m (with electric lock)
Type of oil	FAAC HP OIL	FAAC HP OIL	FAAC HP OIL	FAAC HP OIL	FAAC HP OIL	FAAC HP OIL
Mounting brackets	Rear attachment to be welded/ screwed - front attachment to be welded	Rear attachment to be welded/ screwed - front attachment to be welded	Rear attachment to be welded/ screwed - front attachment to be welded	Rear attachment to be welded/ screwed - front attachment to be welded	Rear attachment to be welded/ screwed - front attachment to be welded	Rear attachment to be welded/ screwed - front attachment to be welded
Dimensions (LxDxH)	1031 x 113 x 85	1031 x 113 x 85	1031 x 113 x 85	1031 x 113 x 85	1285 x 113 x 85	1285 x 113 x 85
Electronic equipment	Not included	Not included	Not included	Not included	Not included	Not included

(*) data referred to 230V~ 50Hz.

FAMILY MODELS

Model	Item code
400 CBC	104205
400 SB	104206
400 SBS	104203
400 CBAC	104201
400 CBAC L	104202
400 SBS L	104220

PACKS

400 includes: a hydraulic operator with hydraulic lock in opening/closing ((**400 CBC**)), without lock (**400 SB**), without hydraulic block for heavy leaves (**400 SBS and 400 SBS L**), a hydraulic operator with hydraulic lock in opening/closing (**400 CBAC and CBAC L**), installation accessories, a release key, a 400V 8 μ F thrust capacitor.

Typical Installation Examples page. 338

ELECTRONIC CONTROL UNITS



E045 electronic control unit
Info at page 144

790005



E145 electronic control unit
Info at page 146

790006

ACCESSORIES



Enclosure mod. L for electronic control units

720118



Enclosure mod. E for electronic control units

720119



Enclosure mod. LM for electronic control units

720309

>>



Plate to be walled

737604



Joint for RTA sheath

710010



SAFEcoder BUS magnetic absolute encoder (FAAC Patent)

404040



BUS XIB interface (for E045 or E024S control unit with non BUS photocell)

790062



Release lock with customised key

712501001-36



Positive Stop - mechanical stops op/cl (can be integrated on mod. 400)

490042

>>



Positive Stop - mechanical stops op/cl (can be integrated on mod. 400 CBAC L)

490043

INSTALLATION DIMENSIONS (MM)

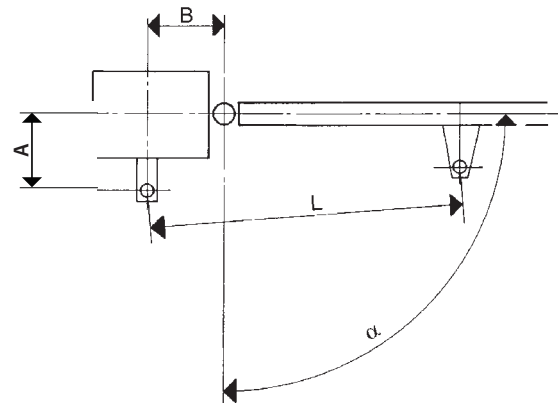

Type	α	A	B	EFFECTIVE STROKE	L
400	90°	130	130	260	960
	115°	100	120		
	125°	90	120		
400 L	90°	200	160	380	1200
	115°	170	160		
	125°	130	170		

NOTE

An electric lock should be installed for operators without hydraulic locking. The 400 L models avoid the use of niches in masonry pillars (FIG.1). The operator with lock is not recommended when there is no access to the manual release device (panelled leaves or no other access to the property).

OTHER ACCESSORIES

Key operated buttons
page 176

Safety devices
page 190

Transmitters and receivers
page 168

Photocells and columns
page 186

Flashing lights
page 198

Various accessories
page 200